

PENTAIR® SHURFLO® PRODUCT INTRODUCTION

40X9 SERIES – RV/CARAVAN FRESH WATER PUMPS

Pentair SHURFLO is proud to introduce a new range of 40X9 series Fresh Water Pumps!

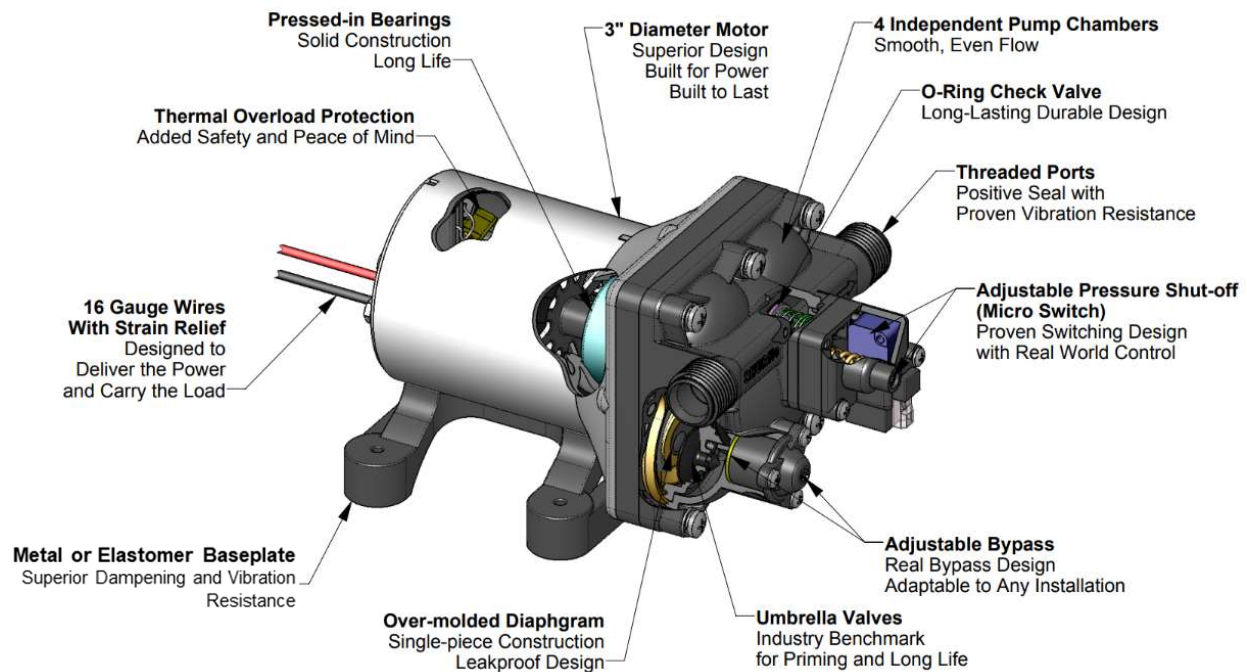

Multi-fixture Fresh Water Pump

SHURFLO's 40X9 freshwater pump design was created with a unique one-piece diaphragm and internal bypass (on applicable models), supporting pump life and performance in all plumbing systems.

Designed as the next legendary pump to exceed the expectations of our customers, the 40X9 series pump is constructed for high flow demand, dampened vibration noise, and elimination of rapid cycling.

Additionally, all SHURFLO 40x9 series models support key regulations in the European Caravan/RV marketing, including Electromagnetic Compatibility with the E8 mark and German drinking water by using all KTW-BWGL compliant wetted materials.

Features

- Compact 4 chambers design
- KTW-tested and approved
- E-Mark certification
- Metal or elastomer base plate available

Benefits

- Fits readily in the same installation space as our 2095-series pumps
- Smooth operation
- Dampened noise

Product Cross-Reference Guide

The Shurflo 40x9 series of pumps is intended to upgrade and replace the pre-existing 2095 series. Following the rollout of the 40x9 series pumps, the 2095 series will be discontinued at a future date. Pentair will provide notification, timing, and an opportunity for last time purchases of the 2095 series in a future announcement.

See the product data table below for cross-referencing 2095 models to the corresponding 40X9 replacement.

Current Product		New Product	
Part Number	Description	Part Number	Description
2095-204-112	MPU 12V 20 SW PES 3.5R 2.0G 1SZF A	4029-281-A32*	12V CE 2G 29BP/20SW MBP OEM
2095-204-412	MPU 12V 20 SW PES 3.5R 2.0G 1SZF A	4029-281-B32	12V CE 2G 29BP/20SW MBP AFT
2095-204-113	MPU 12V 30 SW PES 3.5R 2.0G 1SZF A	4029-281-A54*	12V CE 2G 39BP/30SW MBP OEM
2095-204-413	MPU 12V 30 SW PES 3.5R 2.0G 1SZF A	4029-281-B54	12V CE 2G 39BP/30SW MBP AFT
2095-403-143	MPU 12V 30 SW PES 3.5R 2.8G 1SZF A	4009-201-A54*	12V CE 3G 39BP/30SW MBP OEM
2095-403-443	MPU 12V 30 SW PES 3.5R 2.8G 1SZF A	4009-201-B54	12V CE 3G 39BP/30SW MBP AFT
2095-403-144	MPU 12V 45 SW PES 3.5R 2.8G 1SZF A	4009-201-A87*	12V CE 3G 54BP/45SW MBP OEM
2095-403-444	MPU 12V 45 SW PES 3.5R 2.8G 1SZF A	4009-201-B87	12V CE 3G 54BP/45SW MBP AFT
2095-473-143	MPU 24V 30 SW PES 3.5R 2.9G 1SZF A	4009-231-A54*	24V CE 3G 39BP/30SW MBP OEM
2095-473-144	MPU 24V 40 SW PES 3.5R 2.9G 1SZF A	4009-231-A26	24V CE 3G 47BP/40SW MBP OEM
2095-473-443	PMP 24V 2.8G 30PSI P/S/B AM	4009-231-B54	24V CE 3G 39BP/30SW MBP AFT
2095-292-114	MPU 230V 45 SW PES 3.0R 3.3G 1MPF A	No replacement	
2095-243-444	MPU 13.7V 45 SW PES 3.5R 2.6G 1SZF A	No replacement	

*These models are also available with an elastomer base plate as denoted by a "-K" at the end of the product number.

For additional support in transitioning to the new 40x9 series, please see dimensional reference images provided in the appendix of this document.

Product Availability

The 40X9 series products are now available to purchase. Lead times will vary depending on production schedules and product demand. Order acknowledgements will be used to provide estimated shipping dates.

Contact Information

If you would like further information or assistance transitioning to the new 40X9 series Fresh Water Pumps, please contact your sales representative.

In case you would like to place an order, please send this to Shurflo-orders@pentair.com

Pentair Water Belgium
BVBA
Toekomstlaan 30
B-2200 Herentals
Belgium

Pentair Hypro EU Limited
Unit 9, Bourn Quarter,
Caldecote, Cambridge,
CB23 7FW
United Kingdom

Pentair Manufacturing
Italy SRL
Via Tangenziale Nord
Ticino, 4
28068 Romentino (NO)
Italy

Website: www.pentair.eu

Pentair reserves the right to change products and prices without prior notice. Pentair standard terms, conditions and warranty apply without exception. The Pentair Warranty is limited to the repair or replacement of a defective product or to the issue of a credit note for the amount invoiced to the Purchaser, if warranty claim is judged necessary by Pentair, without any further obligation whatsoever. Pentair shall not be liable for any special, indirect or consequential damages. The Purchaser must test the Product to confirm that it performs as required in their application. The Pentair Warranty is not an express or implied warranty of merchantability or of fitness for a particular purpose.

Appendix: Dimensional Reference Images for SHURFLO 2095 and 40x9 Series

2095-204-112 – Existing pump Model with Metal Base Plate

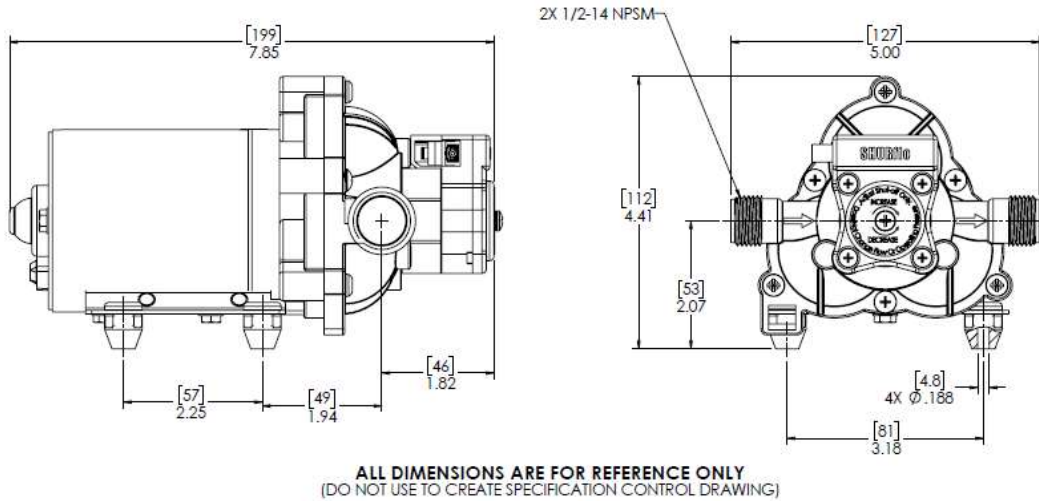

40x9-2xx-xxx Model with Metal Base Plate, same foot pattern as 2095-204-112

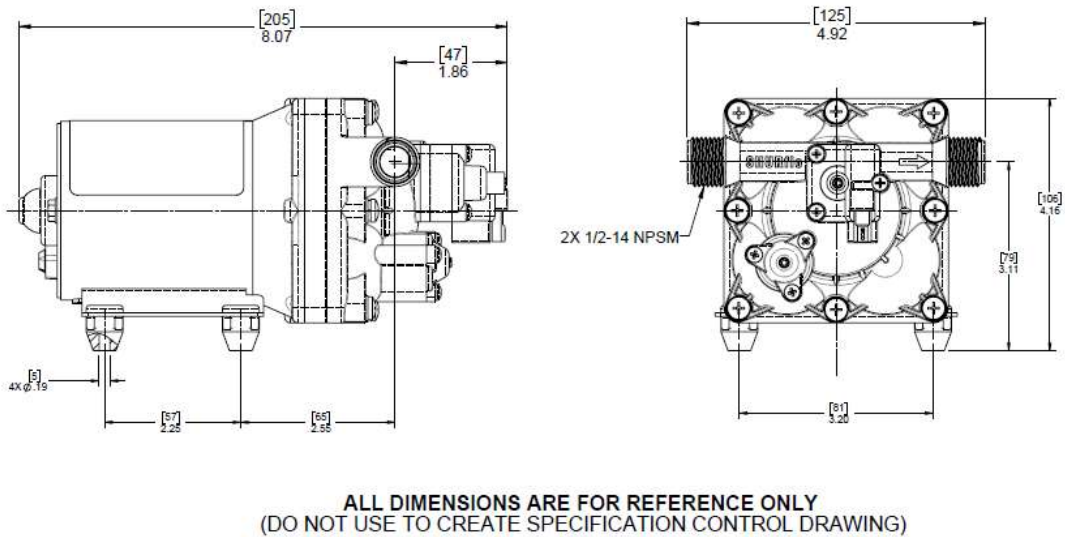

All indicated Pentair trademarks and logos are the property of Pentair. Third part registered and unregistered trademarks and logos are the property of their respective owners.

40x9-2xx-xxxK Model with Elastomer Base Plate

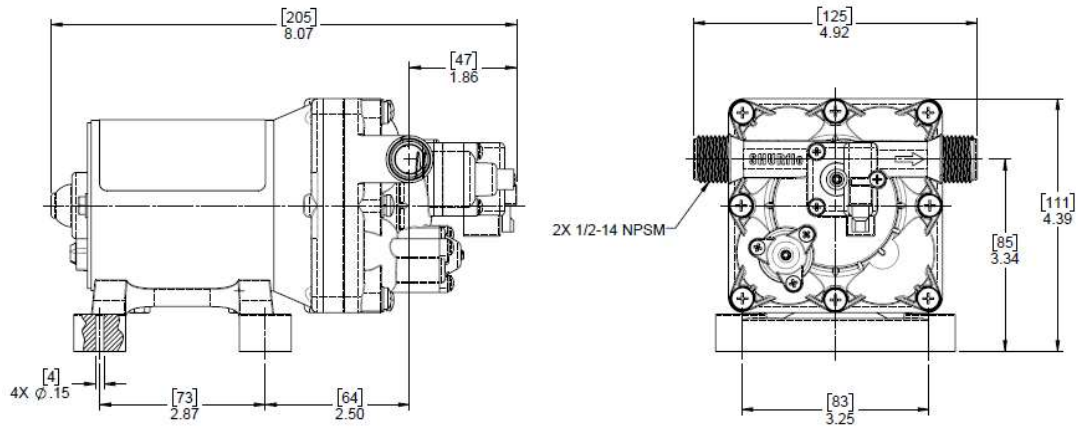

**ALL DIMENSIONS ARE FOR REFERENCE ONLY
(DO NOT USE TO CREATE SPECIFICATION CONTROL DRAWING)**